

Legends Arena Hospitality Suite:  
Layout

To  
BiCentennial  
Stairwell

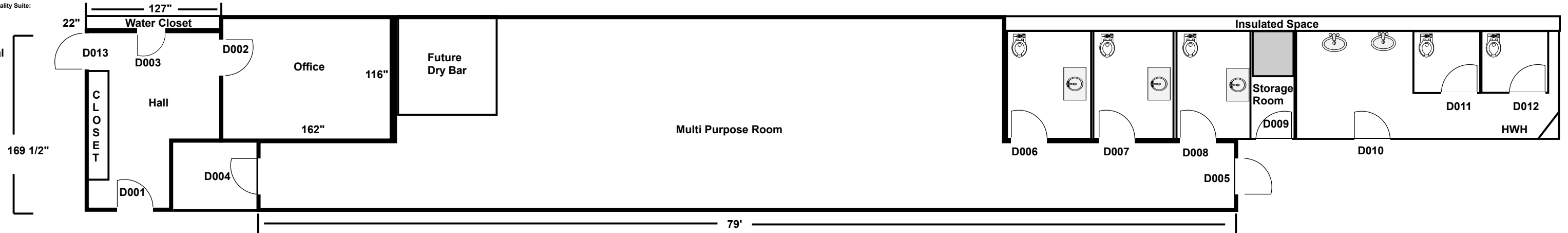

DOOR SCHEDULE

- D001 3' - 0" X 6' - 8" INTERIOR DOOR TO MEET ACCESSIBILITY REQUIREMENTS
- D002 3' - 0" X 6' - 8" INTERIOR DOOR TO MEET ACCESSIBILITY REQUIREMENTS
- D003 2' - 0" X 6' - 8" INTERIOR DOOR TO MEET ACCESSIBILITY REQUIREMENTS
- D004 3' - 0" X 6' - 8" INTERIOR DOOR TO MEET ACCESSIBILITY REQUIREMENTS
- D005 3' - 0" X 6' - 8" INTERIOR DOOR TO MEET ACCESSIBILITY REQUIREMENTS
- D006 3' - 0" X 6' - 8" INTERIOR DOOR TO MEET ACCESSIBILITY REQUIREMENTS
- D007 3' - 0" X 6' - 8" INTERIOR DOOR TO MEET ACCESSIBILITY REQUIREMENTS
- D008 3' - 0" X 6' - 8" INTERIOR DOOR TO MEET ACCESSIBILITY REQUIREMENTS
- D009 3' - 0" X 6' - 8" INTERIOR DOOR TO MEET ACCESSIBILITY REQUIREMENTS
- D010 3' - 0" X 6' - 8" INTERIOR DOOR TO MEET ACCESSIBILITY REQUIREMENTS
- D011 3' - 0" X 6' - 8" INTERIOR DOOR TO MEET ACCESSIBILITY REQUIREMENTS
- D012 3' - 0" X 6' - 8" INTERIOR DOOR TO MEET ACCESSIBILITY REQUIREMENTS
- D013 3' - 0" X 6' - 8" EXTERIOR DOOR TO MEET ACCESSIBILITY REQUIREMENTS

Overlooking Court 1: 1st Floor Arena

2x6 wood between each washroom



**LEGENDS ARENA**  
 LOCATION: 220 Hospital Street, Sydney, Nova Scotia  
 JOB NAME: Front Entry System      DRAWN BY: TL  
 JOB NO. LA-11      SCALE 1/4" = 1'  
 DATE: February 9, 2025  
 DESCRIPTION: Floor Plans, Fixtures, Notes